

PL2000 PORTABLE LATHE

FEATURES ■ SETUP & OPERATION
COMPONENTS & ACCESSORIES ■ TECHNICAL DATA

Compact, rugged lathe for on-site re-turning of small shafts or journals.

A compact, rugged portable lathe for on-site re-turning of small shafts or journals, the PL2000 Portable Lathe mounts on the end of the shaft.

Compact, powerful, precise

- The 0.6 Hp (0.45 kW) electric motor and 5.5:1 gear reduction provides plenty of torque. A 1.22 Hp (0.91 kW) pneumatic motor is also available.
- Tool reach up to 12.5 inches (317.5 mm) from end of shaft.
- Criterion style tool head provides accurate depth adjustments in 0.001 inch (0.0254 mm) increments.
- Turns shafts from 1.5 - 9.0 inches (38.1 - 228.6 mm) in diameter. This compact machine is able to work within a 14-inch (355.6 mm) diameter swing clearance at the end of the shaft.
- Automatic axial feed is infinitely variable from 0 - 0.35 inches/rev. (0 - 8.89 mm/rev.)
- Adjustable tool head and round tool bits allow quick tool positioning for accurate turning.

Quick and easy to set up

- Mounts on the end of the shaft. Simply remove the gear or bearing to expose the end of the shaft.
- The PL2000 can be set up by an experienced operator in less than an hour. Drill and tap four mounting holes on the end of the shaft to attach the mounting flange. The body of the machine is attached, centered, and aligned in a few minutes.

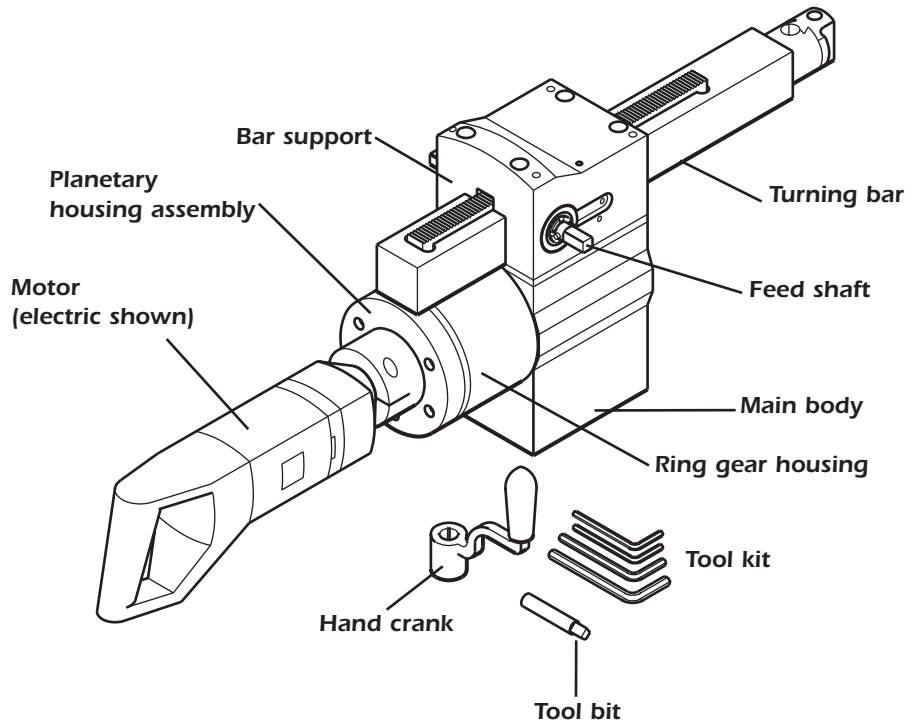

CLIMAX[®]
Portable Machine Tools, Inc.

Specifications

	US	Metric
Overall length, electric bar fully retracted	27.0 inches	685.8 mm
bar fully extended	39.0 inches	990.6 mm
Overall length, pneumatic bar fully retracted	32.0 inches	812.8 mm
bar fully extended	44.5 inches	1130.3 mm
Overall height, without optional spacer/counterweight assembly	13.75 inches	349.3 mm
Overall height, with the optional spacer/counterweight assembly	17.75 inches	450.9 mm
Turning Reach	12.5 inches	317.5 mm
Shaft dia. max, without optional spacer/counterweight assembly	5.0 inches	127.0 mm
Shaft dia. max, with the optional spacer/counterweight assembly	9.0 inches	228.6 mm
Shaft dia. min, without optional spacer/counterweight assembly	1.5 inches	38.1 mm
Shaft dia. min, with the optional spacer/counterweight assembly	5.0 inches	127.0 mm
Feed rate, automatic	0 - 0.035 inches/rev. infinitely variable	0 - 0.89 mm/rev
Cutter	modified 1/2 inch (12.7 mm) HSS round lathe tool bit	
Power, electric 120V, 60 Hz or or 230V, 50Hz	0.66 Hp	0.49 kW
Torque: 40 ft-lbs (53.7 N·m) at 78 rpm bar speed. Bar speed: 52 - 104 rpm max. Motor Speed: 330 - 700 rpm no load, 0 - 420 rpm full load. Variable speed control with 5 detent positions.		
Power, pneumatic	1.22 Hp	0.91 kW
(non-reversing, Hp rated at 200 rpm). Torque: 95 ft-lbs (127.6 N·m) at 55 rpm bar speed. Bar speed: 0 - 96 rpm max. Motor speed: 375 rpm no load, 200 rpm full load. Infinitely variable speed control with needle valve. Air flow required: 90 psi @ 30 ft ³ /min (620 kPa @ 0.85 m ³ /min).		
Operating weight, electric motor without spacers or counterweights	99 lbs	44.9 kg
with spacers and counterweights	116 lbs	52.6 kg
Operating weight, pneumatic motor without spacers or counterweights	94 lbs	42.6 kg
with spacers and counterweights	111 lbs	52.3 kg
Shipping weight	190 lbs	86.2 kg
Shipping dimensions L x W x H	26 x 19 x 15 inches	660.4 x 482.6 x 381.0 mm

All dimensions should be considered reference. Please contact your Climax representative for precision dimensions.

Specifications subject to change without notice

Dimensions in inch (mm)

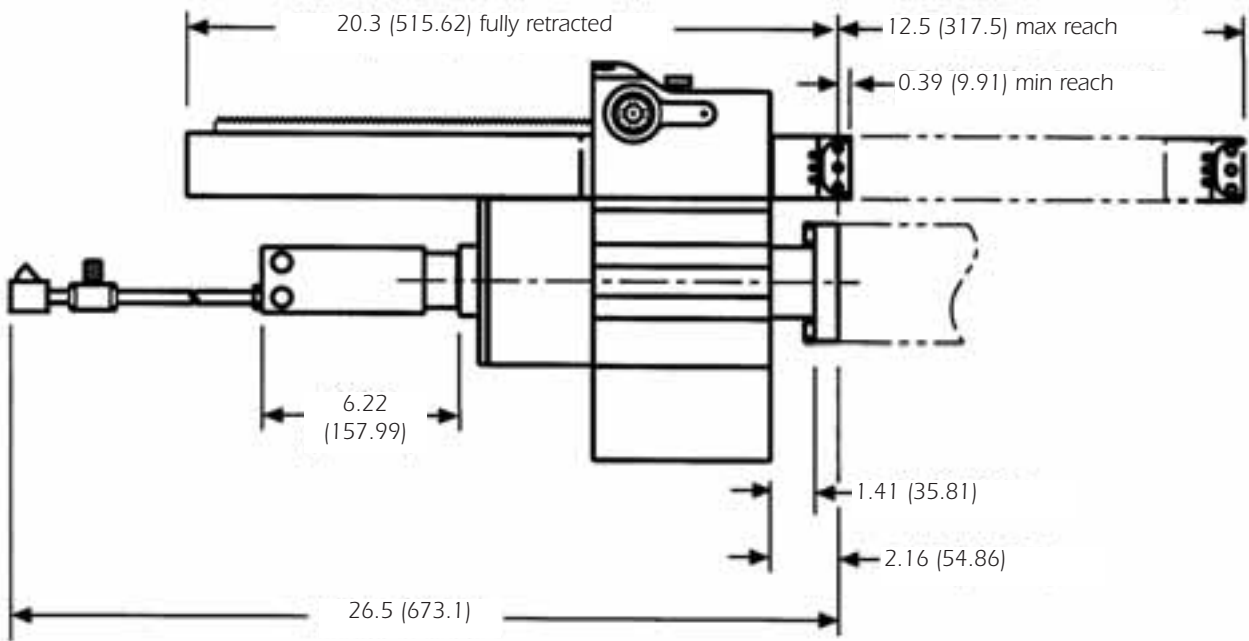
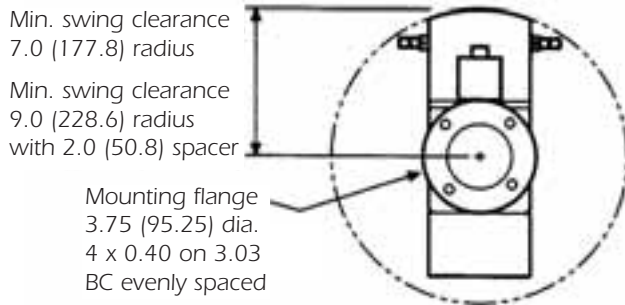
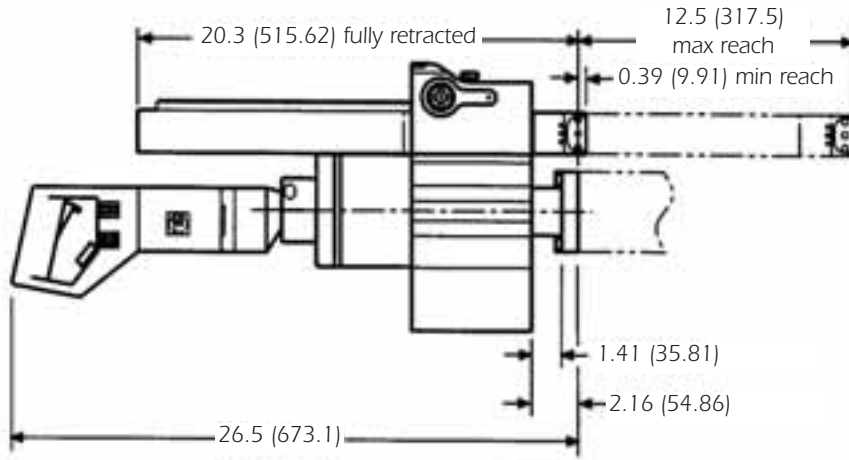

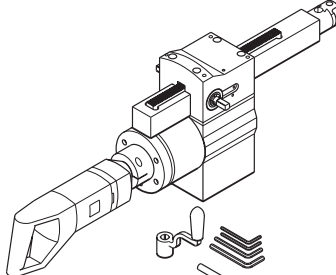
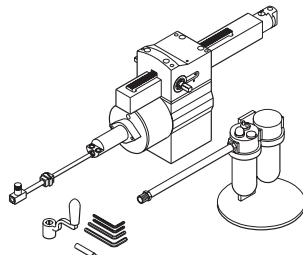
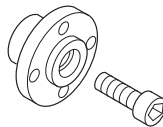
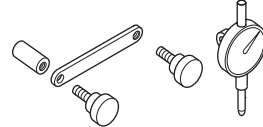
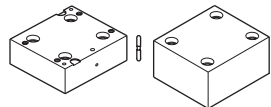
	No. Description
	<p>31591 PL2000 Portable Lathe, Electric 120 V, 60 Hz Standard PL2000 complete with 0.6 Hp (0.45 kW) electric motor, instruction manual, and tool kit. Shipped in wooden crate. Net weight 99 lb (44.9 kg).</p> <p>31593 PL2000 Portable Lathe, Electric 230 V, 50 Hz As above with 230 V, 50 Hz motor.</p>
	<p>31584 PL2000 Portable Lathe, Pneumatic Standard PL2000 complete with 1.22 hp (.91 kW) pneumatic motor, instruction manual, tool kit and pneumatic conditioning unit. Shipped in wooden crate. Net weight 94 lb (42.7 kg).</p> <p>31584CE PL2000 Portable Lathe, Pneumatic, CE Compliant As above with CE approved pneumatic connection package with emergency air shutoff valve assembly.</p>
	<p>30572 Single Bolt Mount Adapter Allows attachment of the PL2000 to the end of the shaft with one bolt. Recommended for shafts under 3.75 inches (95.3 mm) in diameter.</p>
	<p>30407 Dial Indicator Assembly Attaches to tool head for accurately aligning the machine.</p>
	<p>31590 Spacer Assembly Spacer and counterweight assembly. Allows the PL2000 to turn 5.0 - 9.0 inches (127.0 - 228.6 mm) diameter shafts. Includes all mounting hardware.</p>
<p>NOTE: Drawings are for reference only, are not to scale, and may not represent actual product.</p>	<p>37810 Tooling Pack (not shown) One 1/2 inch x 3.0 inch Grooving/plunging tool bit, and one HSS 1/2 inch x 3.0 inch finishing tool bit in storage case.</p>

Call Climax for:

Rentals

With five locations in the USA, two in Canada, one in Europe, and one in Asia, you are never far away from a Climax portable machine tool.

Special Projects

Climax has been solving complicated on-site machining problems for our customers since 1964.

On-site Training

Need some refresher courses in setting up and operating your Climax machine tool?

Call us. We'll bring the solution to you.

PL2-.25M0906

Corporate Headquarters

Climax Portable Machine Tools, Inc.
2712 E. Second Street
Newberg, Oregon 97132 USA
Worldwide Telephone: 503.538.2185
N. America Toll-Free: 800.333.8311
Fax: 503.538.7600
Email: info@cpmt.com

European Headquarters

Climax GmbH
Willi - Bleicher - Strasse 11
52353 Düren, Germany
Telephone: (+49) (0) 2421.9177.0
Fax: (+49) (0) 2421.9177.29
Email: info.de@cpmt.com



CLIMAX®
Portable Machine Tools, Inc.

www.cpmt.com